

Ex

CE

IP
66Ta
45Ta
-25

Ex mark: Ex d IIC T6/T5 Gb
Ex tD A21, T80°C/T95°C, IP66



Light Distribution Curve

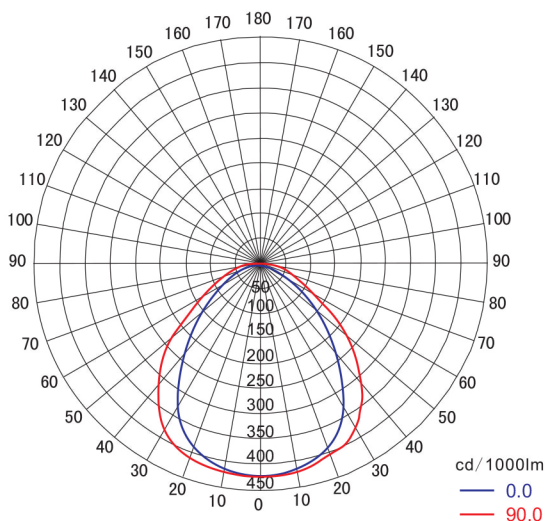

Application

- Ideal to be used in the oilfield, chemical industry, steel industry, power, port, petroleum etc.
- Harsh environment, moist area.
- Gas explosive environment: Group IIA, IIB.
- Zone 1, Zone2; Zone 21, Zone 22.
- Temperature class: T1 to T6.

Characteristics

- Type A: usually can be used for 24 hours of lighting, the accident provides emergency lighting;
- Type B : the accident to provide emergency lighting.
- With its reflector which have different angles design, it efficiently utilize the light. Have a good performance of illuminance uniformity, glare free, can avoid eyestrain to the worker.
- A full range of high conductivity material accelerate convection cooling structure, effective guarantee long term use in high temperature environments.
- It adopts CREE LED as light source, no dark spot, It adopts American CREE LED as light source, can save 60% or more on energy than metal halide lamp.
- The adjustable locking device on the bracket can tightly fix the lamp to any desired angle, making the lamp resist to harsh vibration.
- It is made using aluminum housing, all exposed fasteners adopt 304 stainless steel. Using high-tech anti-corrosion surface treatment technology, suitable for hazardous working areas.
- Intelligent control functions can be realized.

Main Specification

Item	Technical Parameters
Input voltage (V)	90~264VAC
Life time (h)	100,000
Rated frequency	50Hz / 60Hz
Time of charging (h)	>6
Rated capacity	2.6Ah/14.8V
Cable entry	G3/4"
Leading-in cable diameter	φ 9mm~ φ 14mm
Dimension (mm)	370×326×88
Net weight (kg)	9

Rated wattage (W)	Emergency wattage (W)	Emergency light output (lm)	Emergency duration (min)	Mounting height (m)	Equivalent to
					HM
25W	15W	1800	120	2~5	70W/35W
40W	15W	1800	120		100W/35W
60W	15W	1800	120	3~8	150W/35W
25W	25W	3000	70	2~5	70W/70W
40W	25W	3000	70		100W/70W
60W	25W	3000	70	3~8	150W/70W

Drawing of Dimension (Dimensions in mm)

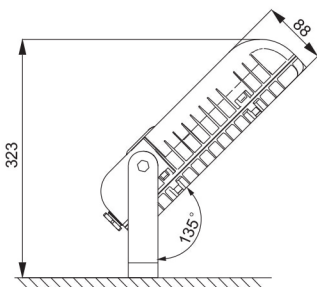

Seat mounting

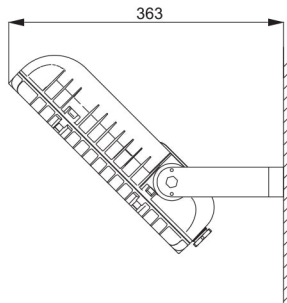

Side wall mounting

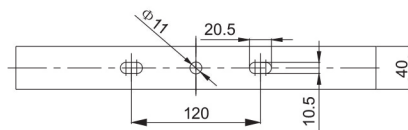
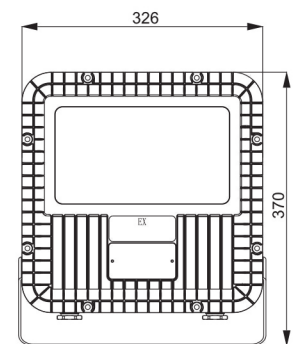

Installation dimension